

**Series 2, Frontloader Washing Machine, 7 kg, , WAJ2017SZA**



**Automatic washing machine with EcoSilence Drive™: quiet operation and durability that you can rely on.**

- **EcoSilence Drive™:** extremely energy-efficient and quiet in operation with a 10-year warranty.
- **SpeedPerfect:** perfectly clean in up to 65% less time.
- **VarioDrum:** especially gentle and efficient washing thanks to a unique drum structure.
- **Reload function:** allows you to add any forgotten items easily while washing.
- **AntiVibration™ Design:** extremely stable and especially quiet thanks to special vibration protection.

**Technical data**

Built-in / Free-standing : Free-standing  
 Door hinge : Left  
 Color / Material body : Silver inox  
 Height for building under : 848.00 mm  
 Height of the product : 848 mm  
 Dimensions of the product : 848 x 598 x 590 mm  
 Wheels : No  
 Net weight : 67.9 kg  
 Drum volume : 63 l  
 Door Frame : Silver inox  
 Noise level washing : 54 dB(A) re 1 pW  
 Connection Rating : 2300 W  
 Fuse protection : 10 A  
 Voltage : 220-240 V  
 Frequency : 50 Hz  
 Energy Star Qualified : No  
 Cord Included : No  
 Plug type : South Africa plug  
 Length of drain hose (in) : 59.05  
 Length of supply hose (in) : 59.05  
 Dimensions of the packed product : 34.01 x 25.39 x 26.37  
 Net weight : 150.000 lbs  
 Gross weight : 152.000 lbs  
 Length of drain hose : 150.00 cm  
 Length of supply hose : 150.00 cm  
 Dimensions of the packed product (HxWxD) : 864 x 670 x 645 mm  
 Gross weight : 68.9 kg  
 Connection Rating : 2300 W  
 Fuse protection : 10 A  
 Voltage : 220-240 V  
 Frequency : 50 Hz  
 Water protection system : Multiple water protection  
 Number of Options : 4  
 Spin speed options : Variable  
 Digital countdown indicator : Yes  
 Drying progress indicator : LED-display

## Series 2, Frontloader Washing Machine, 7 kg, , WAJ2017SZA

**Automatic washing machine with EcoSilence Drive™: quiet operation and durability that you can rely on.**

- Ferrite-BLDC
- BLDC with warranty

### Engine power/Consumption

- Capacity: 7 kg
- Energy Efficiency Class: A+++
- Energy consumption :139 kWh per year, based on 220 standard washing cycles
- Energy consumption:standard 60 °C cotton programme 0.85 kWh full load and 0.55 kWh partial load and 40 °C cotton programme 0.34 kWh partial load
- Weighted power consumption off-mode / left-on mode: 0.12 W / 0.5 W
- Water consumption 9900 litres per year, based on 220 standard washing cycles
- C spin class
- Maximum spin speed: 1000rpm  
Remaining moisture:62 %
- Cottons60°C+buttonEcoPerfect and Cottons40°C +buttonEcoPerfect are the standard washing programmes to which the information in the label relates. These programmes are suitable to clean normally soiled cotton laundry and are the most efficient programmes in terms of combined energy and water consumption.
- Programme time:60 °C cotton programme 225 min at full load 210 min at partial load and 40 °C cotton programme 210 min partial load
- Programme time:60 °C cotton programme 225 min at full load 210 min at partial load and 40 °C cotton programme 210 min partial load
- Noise level spinning:72dB (A) re 1 pW:

### Programmes

#### Options

- VarioPerfect: time- or energy optimized programs with perfect wash performance
- varioSpeed: Up to 65% reduced washing cycle
- Touch control buttons

### Comfort and Safety

- Reload function: Be flexible in adding laundry items even after start of the wash cycle.
- Reload Function: Stop the already running washing machine to add any forgotten items of laundry to the drum.
- waveDrum
- Multiple water protection
- Large display for programme progress indication, temperature, spin speed, remaining time, 24 h end time delay and load recommendation
- Large display for temperature, spin speed, remaining time, 24 h end time delay and load recommendation
- Fully electronic control dial for all wash- and special programs
- AntiVibration Design: more stability and quietness
- anti-vibration Design: more stability and quietness
- 3D AquaSpa wash system with cascade for faster water penetration
- Recommended Load
- Loading introduction
- Foam detection system
- Safeguard monitoring system adjusts load distribution
- easy clean
- Child Lock
- Buzzer
- Metal door catch
- magnet with pull-open latch

### General Information

- Dimensions (H x W x D): 84.8 x 59.8 x 59 cm
- Slide-Under

**Series 2, Frontloader Washing Machine, 7  
kg, ,  
WAJ2017SZA**

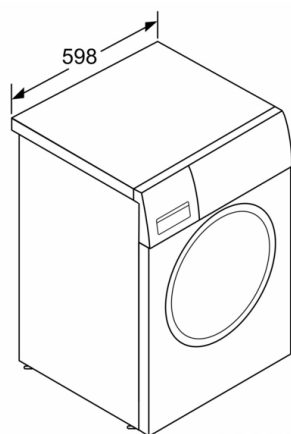

measurements in mm

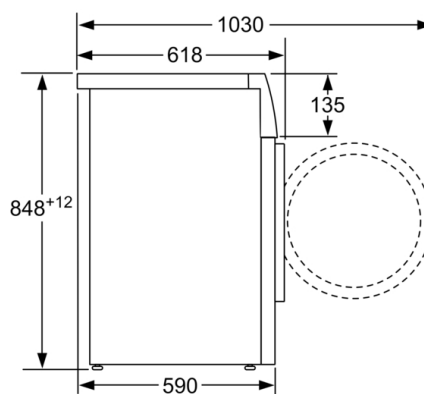

measurements in mm